

- Verify that all items listed are present and inspected for shipping damage. This package includes:
- (1) μCUBE expansion enclosure
 - (1) Cable adapter (PCIe only)
 - (1) Cable (PCIe or Thunderbolt)
 - (1) External power supply
 - Quick Start Guide
- If you encounter a missing or damaged item, call us toll free at 1-888-236-5454 and we will be happy to assist you

1 Ensure that you have received everything.

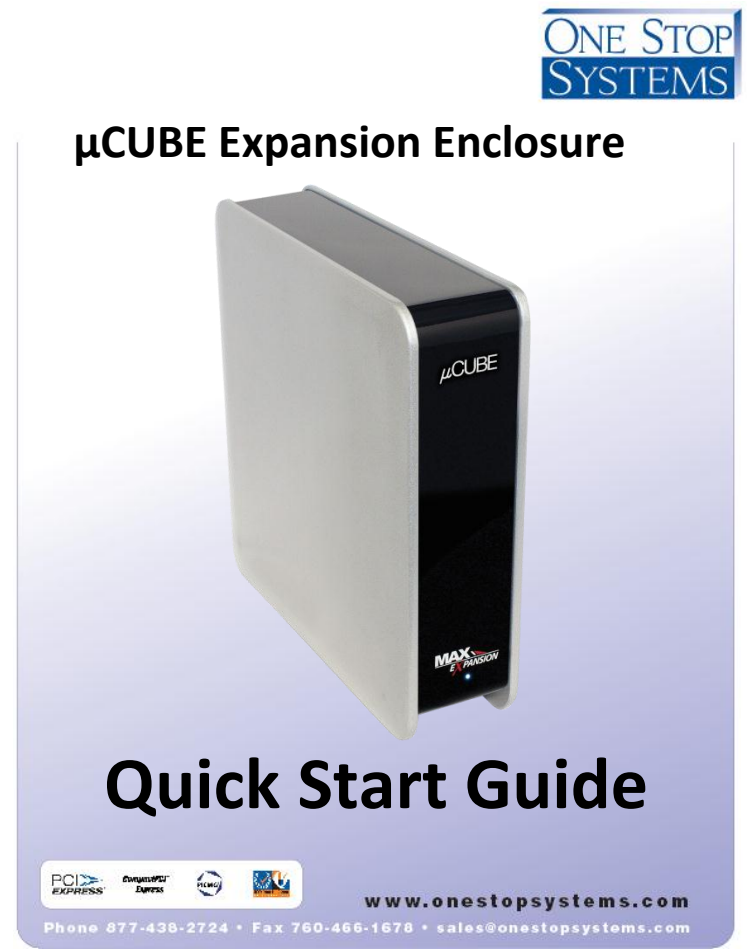

- Electrostatic charges (ESD) easily build up in the body and can be damaging to your computer. For this reason it is vital to create an ESD safe environment when working with computer components.
- Always unplug the power cable before opening the enclosure

2 Create an ESD safe environment.

The μCUBE desktop enclosures dramatically increase your system's performance by supporting from one to five I/O short cards. Loosen only one access screw to install your add-in card(s) into the μCUBE. Attach the PCIe cable adapter or Thunderbolt cable to your PC and instantly your PC delivers increased performance with no additional software require, making the installation quick and easy.

The μCUBE is a trademark of One Stop Systems, Inc.
Thunderbolt is a trademark of Intel Corporation

- Properly ground yourself (grounded wrist strap or ESD-protective mat)
- Do not touch cards if you are not properly grounded.
- When possible, handle cards only by the metal bracket or by their edges
- Avoid touching any cards or components unnecessarily
- Remember, you may not even feel a shock that could severely damage your computer

Warranty

All OSS products are backed by our 2 year limited warranty.

Enjoy your new μCUBE!
Follow the steps in this quick start guide to quickly and easily use your new product.

3

Familiarize yourself with the product.

Rear View:

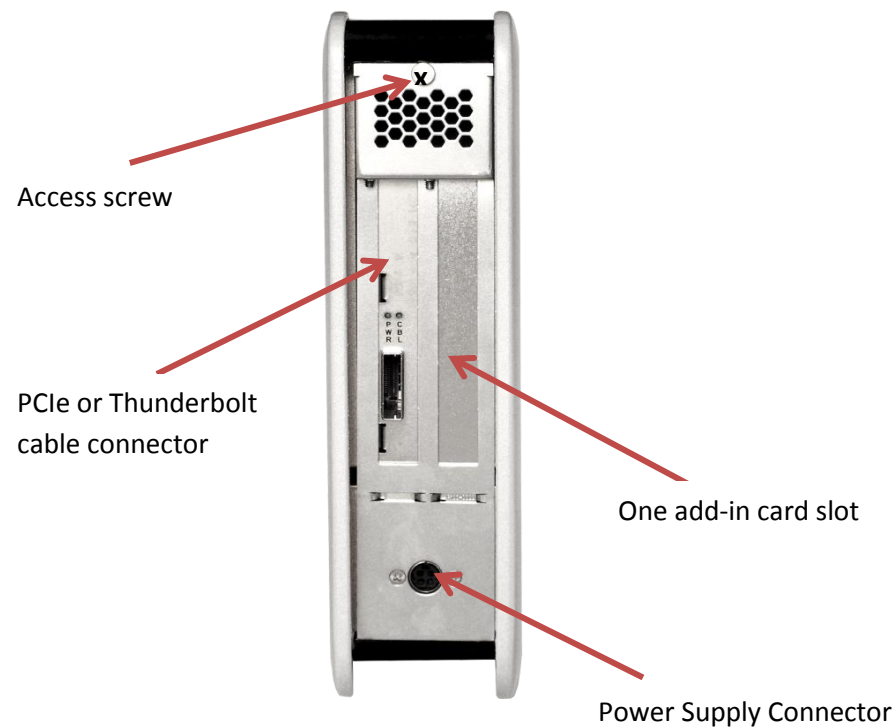

Inner Components:

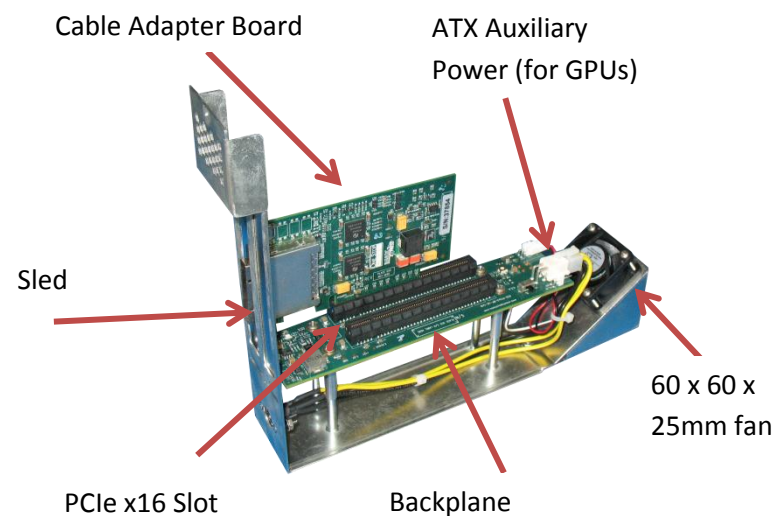

4

Configuring the μCUBE:

Opening the μCUBE

1. Remove all items from their packaging including:
 - a. μCUBE enclosure (includes chassis, sled with backplane and target cable adapter)
 - b. (1) Host cable adapter card
 - c. (1) Cable
 - d. (1) External power supply

Add-in Card Installation

2. Remove the sled from the μCUBE enclosure
 - a. Unscrew the access screw located at the top of the sled.
 - b. Remove the sled from the chassis.



3. Install your add-in card

Screwdriver

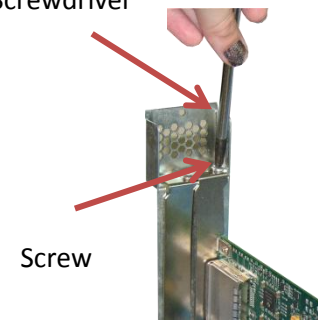

- a. Carefully align the add-in board connector with the PCIe connector on the backplane and press firmly into place.
- b. Replace the screw on top of the card bracket, securing the newly-installed board into place in the tray.
- c. Always use a slot cover for any unused slots on the rear panel.



4. Replace the sled



- a. Slide the sled back into the chassis.
- b. Replace the access screw at the top of the sled.

Cabling the μCUBE to your computer

5. For PCIe connection to your PC or workstation

- a. To insert the PCIe cable, line up the keyed side of the cable connector with the keyed side of the connector on the board and insert.
 - i. Pull back the green tab on the retractor to allow the cable to lock into place.
 - ii. The teeth of the cable connector must be completely seated.
- b. Install the cable adapter in a PCIe slot in your PC or workstation.
 - i. Place the cable adapter card in an open slot in your computer (the cable adapter will only operate at the base speed of the slot. Ex: a x8 card in a x16 slot operates at x8 speeds.)
 - ii. Fasten the adapter card in the slot by tightening the screw on the slot cover.



6. For Thunderbolt Connection

- a. Connect the Thunderbolt cable to the Thunderbolt connector in your workstation or laptop.
 - i. The cable can be connected to either of the Thunderbolt connectors on the μCUBE.

7. Insert the power cable and turn on your computer to power up the μCUBE.

8. Install any driver required for the add-in card(s) on your computer.